



APPLICATION FOR CERTIFICATE OF APPROPRIATENESS

Send completed application and check to: Meridian Street Preservation Commission 200 E. Washington Street, Suite 1821 Indianapolis, IN 46204

MSPC Case No.: MSPC-10-05

Address of the Property where work is to be done: 4375 N. Meridian St.

Applicant's Name: Jennifer Medley
Address: 4375 N. Meridian St, Indpls, IN 46208
E-Mail address: jaconnolly@hotmail.com
Phone No: 317-496-2303
FAX No: 317-217-3268
Zip Code: 46208
Name of Owner(s): Jennifer & J. Andrew Medley
Address of Owner: Same as above
E-Mail address: [down arrow]

The present Use of the property is: residential
The current Zoning Classification of the property is: residential
Will the Use change under the proposed work? [ ] Yes [X] No
If yes, to what? [ ]

The work being proposed will be on/for (check all that apply):
[ ] New building [X] Site Work/Landscaping
[ ] Renovation or Remodel of Primary structure [ ] Demolition of Primary structure (partial or complete)
[ ] Renovation or Remodel of Accessory structure [ ] Demolition of Accessory structure (partial or complete)
[ ] Other (describe): [ ]

Detailed Description of work to be done (attached additional sheets if necessary):
Installing approx. 46' of black ornamental steel 3-rail picket fence extending from front of house to adjacent fence-line on either side of property, 10' single swing gate across driveway, 4' walk gate on south side, quad-flair finials on fence/gates

The work will be done by: [ ] Owner [X] Contractor [ ] Other
Contractor's Name: in negotiation w/ Glidden Fence Co & Bullseye Fence Phone: 844-5657 445-6883 Fax:
Date of start: upon approval - April 2010 Date of completion: April 2010

Documentation submitted (10 copies required of any information submitted):
[X] Site Plan, legible & drawn to scale (required) [X] Photographs (required)
[X] Building plans, elevations (required) [X] Samples/Swatches
[ ] Drawings/Sketches [ ] Other

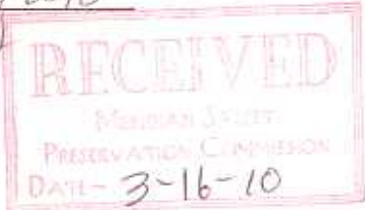

I (we) affirm, under the penalties for perjury, that the foregoing representations are true.
Signature of Owner: [Signature] Date: 2/24/10

Signature of Applicant (if different than Owner) Date

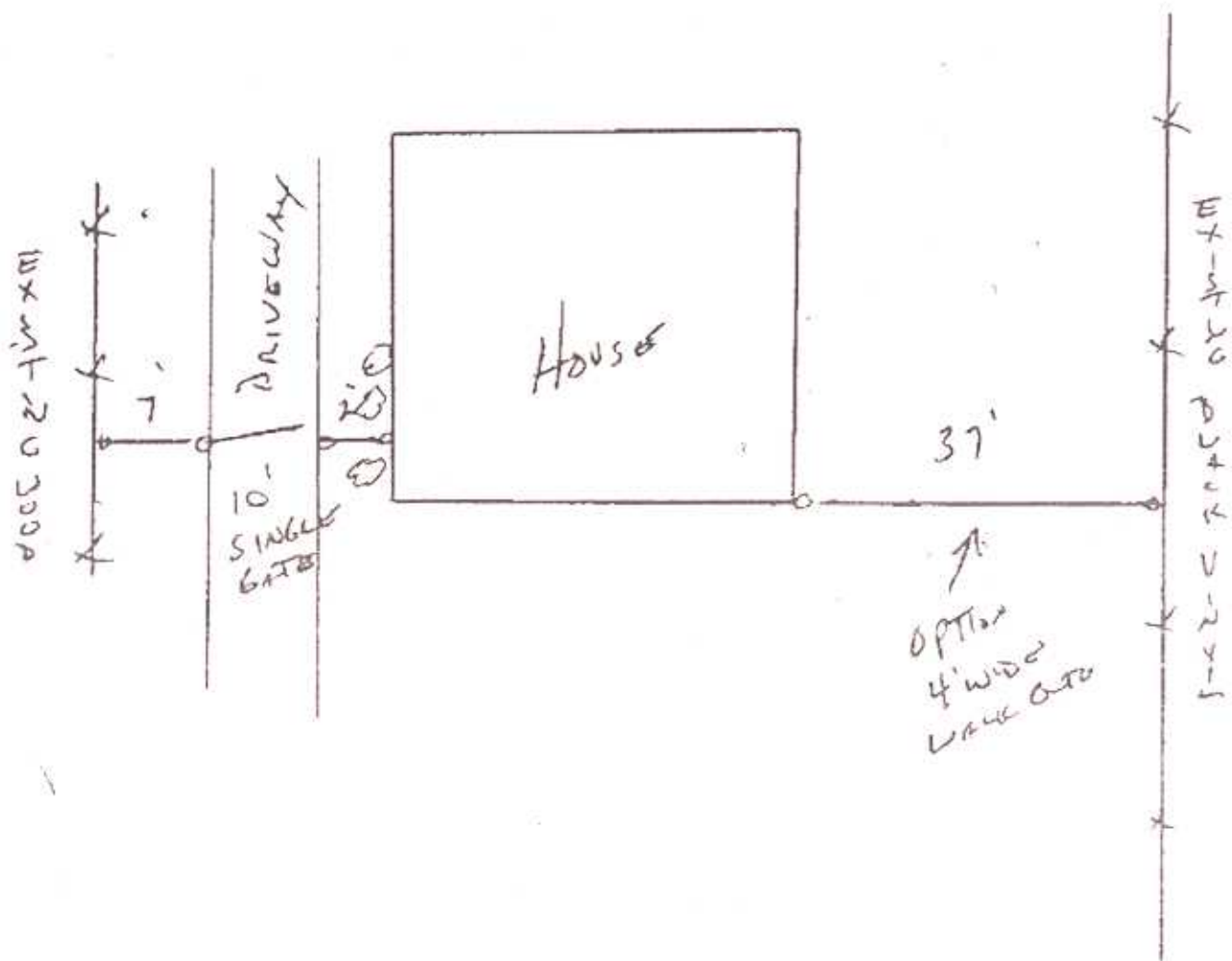

# GENESIS



**GENESIS**  
3-Rail  
Commercial Business



**GENESIS**  
3-Rail With Quad-Flares  
Neighborhood Perimeter

The Genesis style carries an inherent beauty that adds a decorative touch to any residential landscape, whether an individual home, a gated community, or a series of multi-family dwellings.



**GENESIS**  
3-Rail With Rings & Rings  
Ranch Perimeter

The addition of a row of rings between the top two rails is a wise choice in two ways: it enhances the decorative look while it nearly doubles the strength of the fence.



**GENESIS**  
3-Rail With Triads & Rings  
Railroad Barrier

U.S. Patent No.  
6,811,145



**Welded  
Extra Strength**

**GENESIS  
Added Options**





